



12.8V100Ah LiFePO4 Battery



High energy density, no pollution



Built-in BMS



Protect voltage, current, temperature in whole process



10 years design life

Enershare Tech Company Limited

Tel: 0086-755-28748610 E-mail: vivian@enershare.cn

<https://www.enershare.cn>

12.8V100Ah LiFePO4 Battery



1. Overview

LFP-12100L is 12.8V100Ah Lithium iron phosphate battery module which designed for UPS, solar system, portable devices, energy storage and medical cart applications. This battery module integrated with intelligent BMS inside, has big advantages on safety, cycle life, energy density, temperature range and environmental protection. This product specification describes the type, size, structure, electrochemistry performance, service life, and BMS characteristics.

2. Advantages

The battery module consists of single LFP cells, wire, BMS and container.

- Packed with high performance LFP single cell, long life, safety and wide temperature range
- High energy density, small size, light weight, no pollution;
- High efficiency, fast charging;
- Built-in BMS, protect voltage, current, temperature in whole process
- Standard VRLA battery case , can replace the VRLA battery directly
- Customize dimension and capacity, Support maximum 4 batteries in series
- 10 years design life, Stable performance, maintenance-free

3. Module Drawing

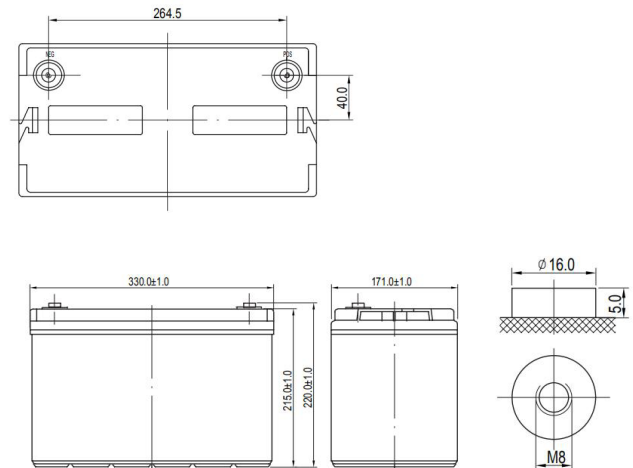

4. Application scenario



Sailboat



RV



Residence



signal tower

12.8V100Ah LiFePO4 Battery

5. Parameters

Item	Specification
Rated Voltage	12.8V
Rated Capacity (0.2C, @25°C)	100Ah
Rated Energy	1280Wh
Cell & Pack	LiFePO4, Prismatic, Aluminum shell
Output voltage range	10.8V~14.6V
Charging voltage	14.6V, CC-CV
Cut-off voltage	10.8V
Max. Constant Charging current	100A
Recommended charging current	50A, best @ 20A
Recommended charging type	CC-CV until current <0.02C
Max.Constant Discharging current	100A
Efficiency	≥ 99.5%
Built-in BMS	
Over-charge protection	Cell>3.65V
Over-discharge protection	Cell<2.5V
Over-current protection Short circuit protection	Charging: >110A,; Discharging: >110A; Short circuit: 1000A
Cell balance	Passive, 20mA
Over temperature protection	Charging: 50°C Discharging: 65°C
Case material	ABS
Dimension L*W*H (mm) & Terminal	330*171*215, M8
Weight (kg)	9.5
Environment	
Humidity	5%~95% relative humidity
Charging temperature	0°C ~+45°C
Discharging temperature	-20°C ~+60°C
Storage temperature	-5°C ~35°C
Service Life	
Cycle life	80%DOD>6000 times, @0.5C, 25°C
Design life	>10 years